

N Series

Flexible, Smart, Light



Online
Service



Creative Flat TV design

Light and slim, makes installation easy and saves space.

Front & Rear Maintenance



Holes for front installation

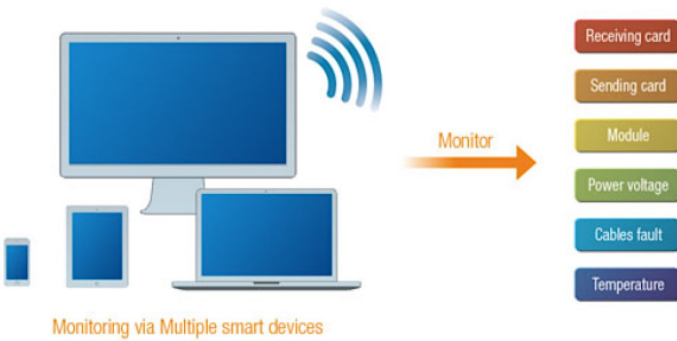

Monitoring via Multiple smart devices

Intelligent monitoring, real time feedback

- Monitor without card, fewer cables and fault points.
- Real-time monitor work status, immediately email when malfunction, which reduces response time and cost for troubleshooting.
- Monitoring via PC, Tablet, Mobile phone are available. (N3,N4,N4D,N5)

A3C, Great Visual Feast

- Absen 3rd generation calibration, better image.
- Data are stored inside module, which makes calibration easy while switching modules.



Before / After Calibration

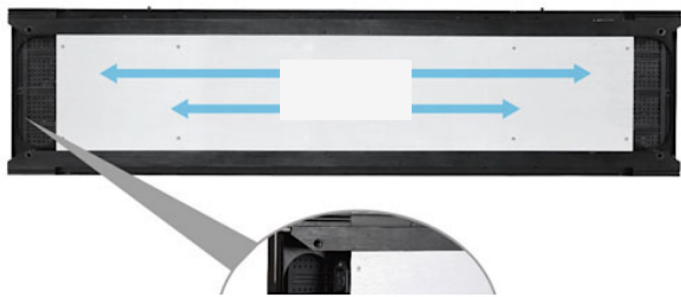

Convenient and
Reliable

Sub-frame, fast
installation

4 in 1 sub-frame / panel installation
bar, makes installation fast.

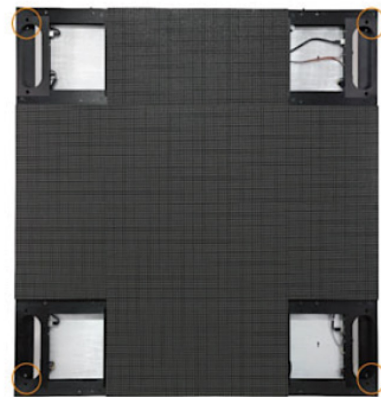

N2/ N3/ N4/ N4D/ N5 -SPECIFICATIONS

Technical Specifications		N2	N3	N4	N4D	N5
Physical Parameters	Pixel Configuration	SMD 1010	SMD 2121	SMD 2121	SMD 1921	SMD 2121
	Pixel Pitch (mm)	2.4	3.2	4	4	5.14
	Pixel Matrix per Panel	240×120	360×90	288×72	288×72	224×56
	Module Dimensions (W×H) / (mm)	288×288	288×288	288×288	288×288	288×288
	Panel Weight (kg)	5	8.8	8.8	9.2	8.8
	Panel Material	Aluminum				
	Panel Dimensions (W×H×D)/(mm)	576×288×57	1152×288×54			
Electronic Parameters	Color Grayscale (Bit)	16				
	Grey Scale per Color (Level)	65536				
	Refresh Rate (Hz)	1920				
	Frame Frequency (Hz)	50/60				
	Signal Transmission Distance	UTP cable: <100 m; Single-mode fiber: <10 km				
	Drive Mode	1/20	1/15	1/12	1/12	1/7
Optical Parameters	Brightness (nit)	1000	1000	1000	4000	1000
	Color Temperature (K)	7500	7500	7500	7500	7500
	Contrast Ratio	4500:1	2100:1	3000:1	3800:1	3000:1
	Horizontal Viewing Angle (°)	160				
	Vertical Viewing Angle (°)	140				
	Electrical Parameters	AC Input Voltage (V)	100~240			
AC Input Frequency (Hz)		50/60				
Maximum AC Input Power (W/m ²)		720	450	450	540	450
Average AC Input Power (W/m ²)		240	150	150	180	150
Environmental Parameters	Storage Temperature (°C)	-40~+60°C				
	Working Temperature (°C)	-10~+40°C				
	Storage Humidity (RH)	10%~90%				
	Working Humidity (RH)	10%~90%				
	IP Rating (Front/Rear)	IP50/IP51	IP50/IP51	IP50/IP51	IP50/IP21	IP50/IP51
	Typical Life (hrs)	100,000				
Product Installation	Panel Installation Method	Fixed Installation				

107, rue de Javel
75015 Paris

Contact: Alexandre Verselle
Tél: +33 1 81 69 37 47

@: alexandre@luminescence-led.com
Web: www.luminescence-led.com